

## 125-2001/2101 Filling elbow DN100



### 1. General

Different countries have different solutions for filling the underground storage tanks (UST) at service stations. In northern Europe it is common practice to use filling elbows normally mounted in a special environmental box.

The elbow moves the opening up from ground level which is required during the harsh winters when snow and ice will make an opening at or below ground level difficult to access. It also prevents water from getting into the tank.

The aluminium elbow comes with or without integrated dip tube and also in some cases chromed to withstand E85.

Item no.	With dip tube	For E85
125-2001	No	No
125-2001E	No	Yes
125-2101	Yes	No
125-2101E	Yes	Yes

## 2. Installation

The elbow must be mounted professionally. The wrench grip simplifies the installation

Always apply normal best practice and the customer's internal installation regulations.

## 3. Dimensions and material

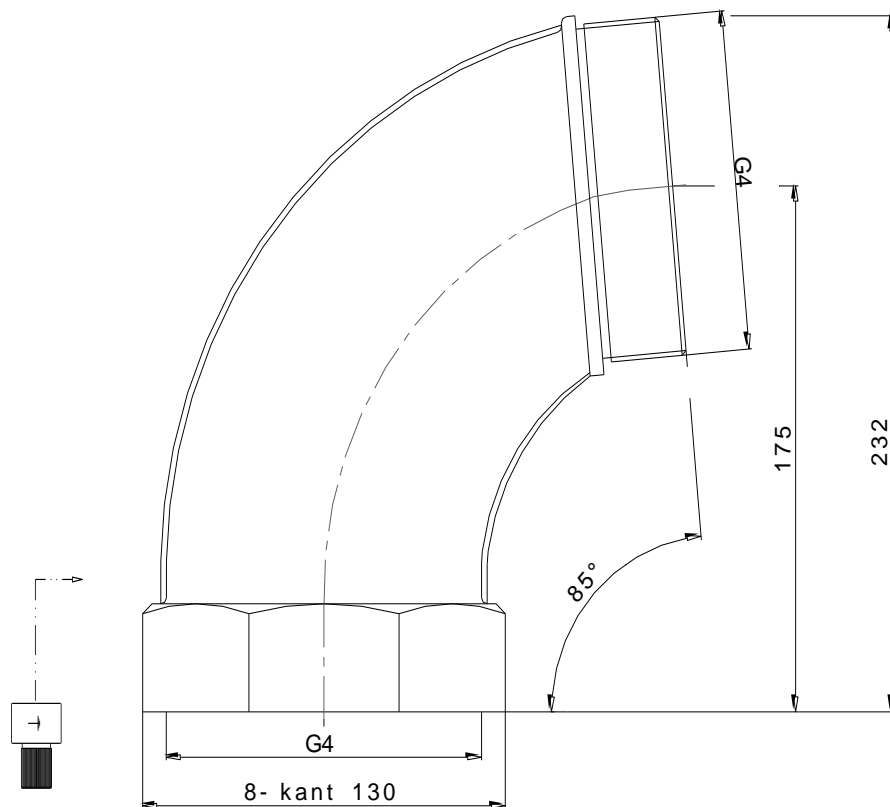

Material	Aluminium SS4253-04
Height	232 mm
Angle	85°
Connections	Female G4/ male G4
Weight	1.0 kg
Earth Clamp	10mm <sup>2</sup>